



BLUE ZONE PAVILIONS & OFFICES

Introduction & background



INTRODUCTION – WHAT IS A COP?

- The COP is the United Nations Climate Change “Conference of the Parties”.
- 199 parties (198 states plus the EU) are party to the United Nations Framework Convention on Climate Change.
- The 28th session of the COP (COP28) will be held in Dubai, from the 30th November 2023 –12th December 2023.
- The COP is the world’s highest decision-making body on climate issues and meets annually to tackle climate action.
- The two-week annual event brings together Heads of State, climate experts, political leaders, young people, Indigenous Peoples and civil society to collaborate on the crucial challenge of climate change.

WHERE WILL COP28 UAE TAKE PLACE?

COP28 will take place at Expo City, Dubai.

The event is split into two zones, the Blue Zone and the Green Zone (distinctions between the two are clarified on the next slide).

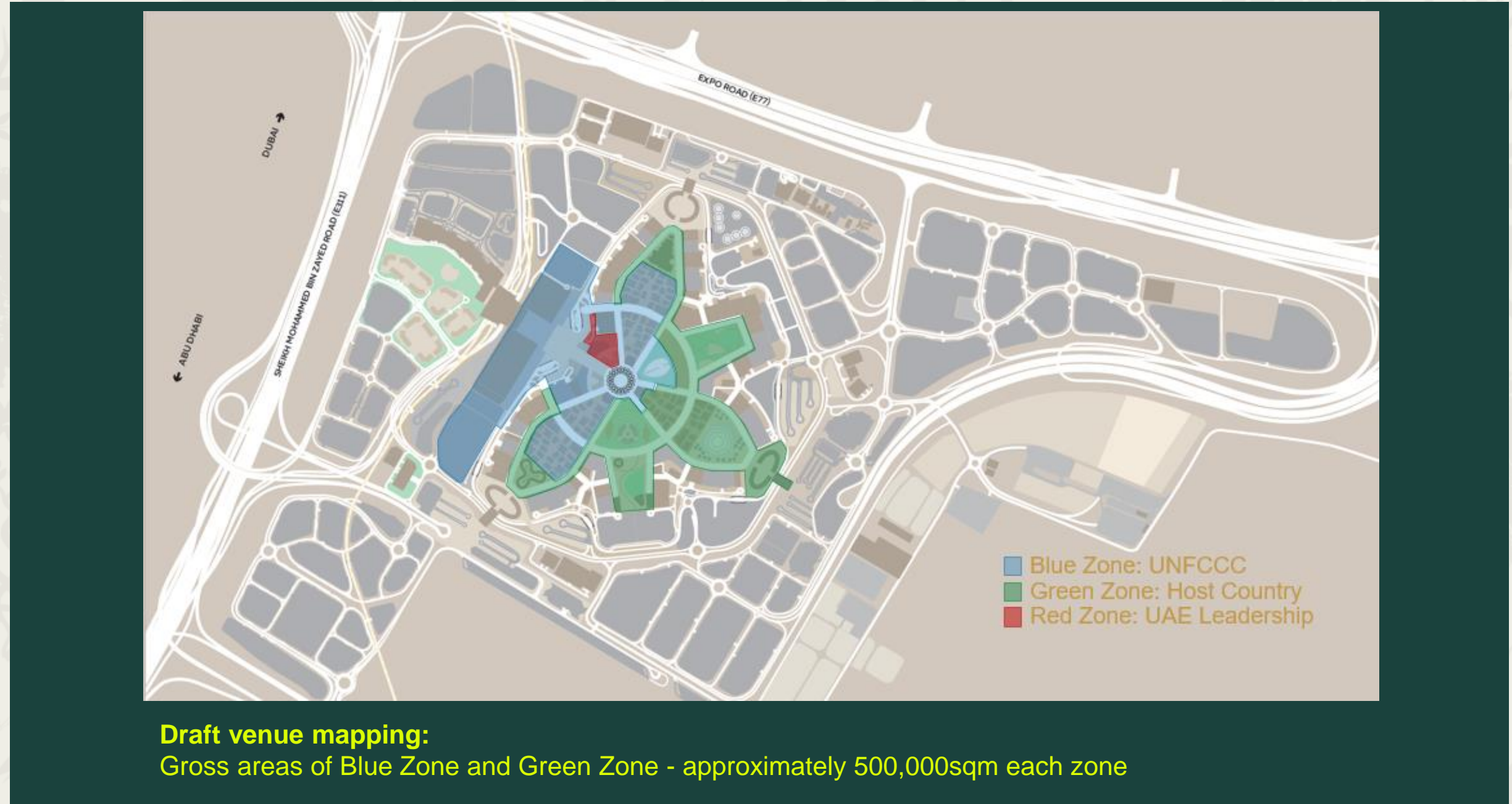

Blue and Green Zone overview



BLUE ZONE

UNITED NATIONS NEGOTIATIONS AREA

The Blue Zone is a UNFCCC managed site, open to accredited party and observer delegates.

It hosts the formal negotiations across the two weeks of the event, as well as the World Climate Action Summit, the country pavilions, presidency events and hundreds of side events including panel discussions, round tables, and cultural events.

Attended by:

- Parties (Heads of State, Ministers, Negotiators)
- Observers (NGOs, IGOs, UN Agencies)
- Media
- World Leaders

GREEN ZONE

PRESIDENCY AREA

The Green Zone is managed by the UAE Government and is a platform for the general public, youth groups, civil society, indigenous groups and the private sector to have their voices heard, promoting dialogue, awareness and commitments about climate action.

The Green Zone will provide a platform for discussion, culture and entertainment and for businesses to showcase innovative solutions, technologies and products across three exhibition areas: Decarbonization Hub, Technology and Innovation Hub and the Knowledge Hub.

EXPO CITY: A CONNECTED CAMPUS

Expo City Dubai is an innovation-driven, people-centric city that is designed as a blueprint for sustainable urban planning, galvanizing action on its journey to carbon neutrality. Spanning 4.38 sqkm, Expo City is a car-free site that features three districts – Opportunity, Mobility and Sustainability – with a 5km running track, 10km of cycling tracks, children’s playgrounds and 45,000sqm of parks and gardens.

At the center of the three districts is Al Wasl, a plaza enclosed by a dome that acts an immersive 360-degree projection surface and a hub during Expo 2020 and beyond.

In line with our values to support every community to engage with COP28 UAE, the venue will be universally accessible.



BLUE ZONE

PAVILIONS AND OFFICES

COP28UAE

SITE OVERVIEW

The Expo City seamlessly incorporates the COP28 Blue and Green zone.

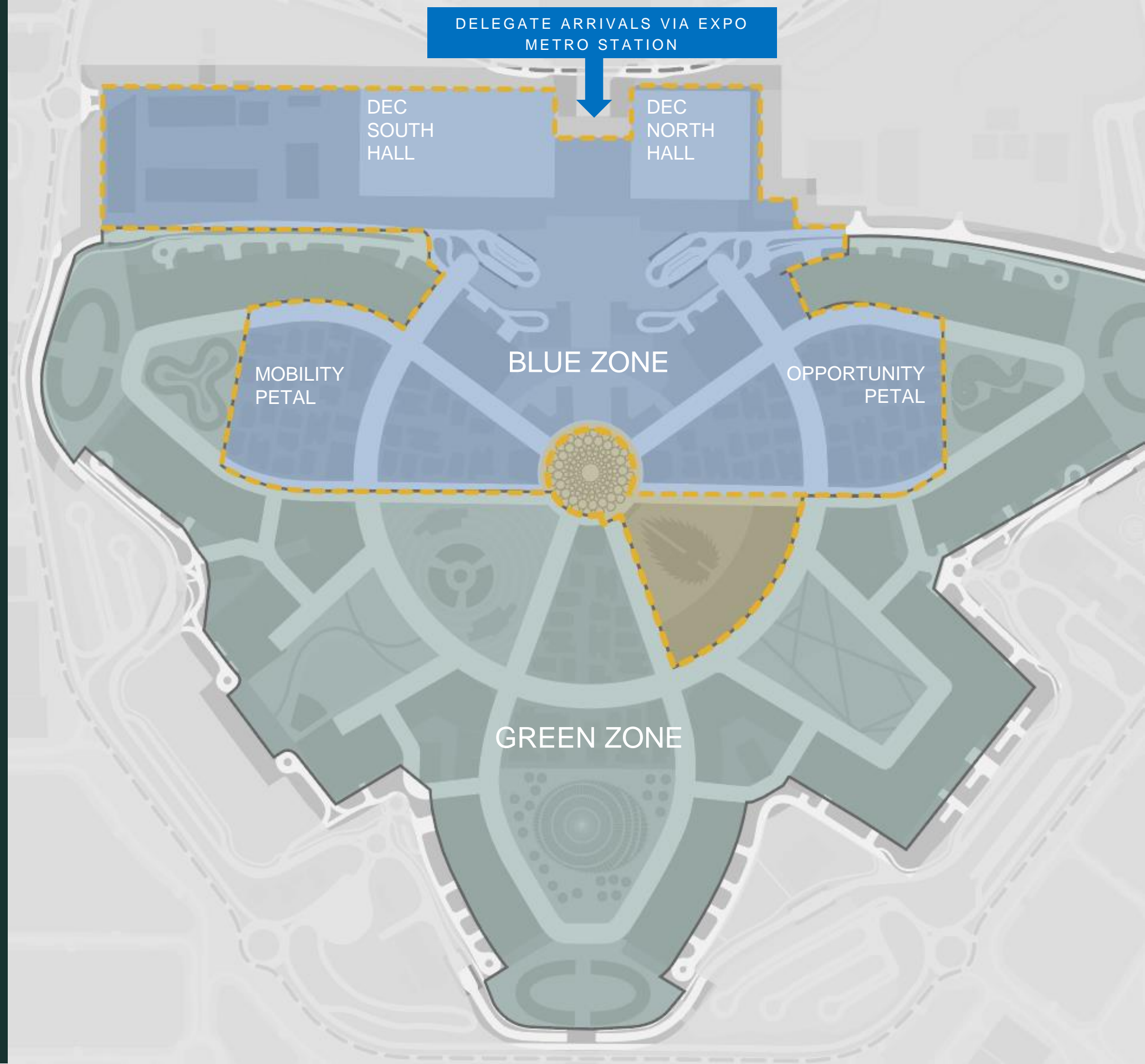
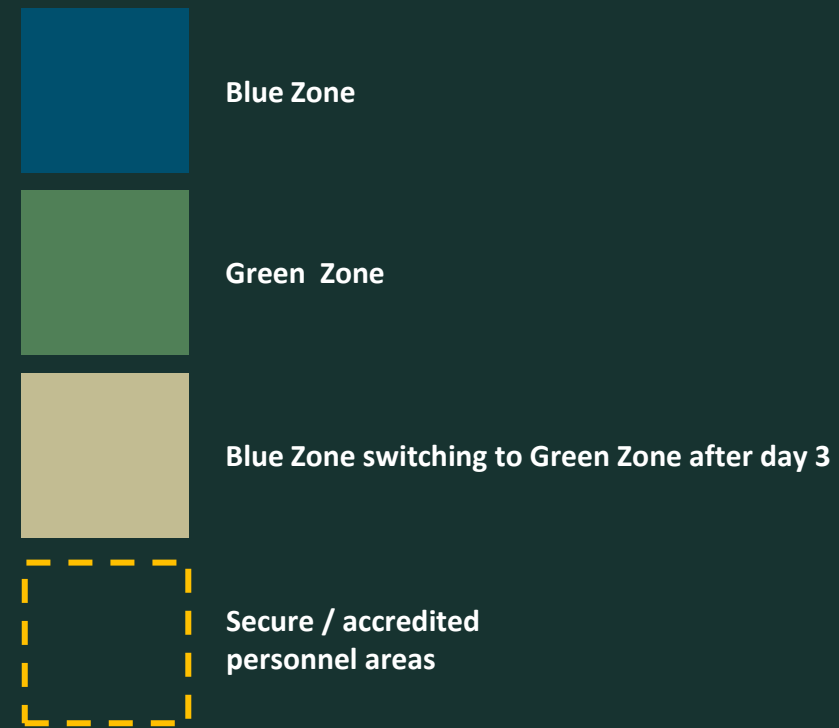



BLUE ZONE PAVILION & OFFICE SPACES

BLUE ZONE PAVILIONS

Expression of Interest (EOI)

- The Blue Zone Pavilions Expression of Interest (EOI) will be published on the COP28 official website on **10 May 2023**.
- Submissions are open for accredited observer organizations and Parties.
- The EOI process will be open until **15 June 2023**.
- Submission of your EOI does not guarantee that your requirements will be automatically granted. Instead, it is part of our event planning process. We will endeavor to fulfill your requirements as much as possible.
- Upon closing, all applications will be reviewed, and space allocations will be completed upon consultation with the UNFCCC secretariat.



BLUE ZONE PAVILIONS

Overview

- Blue Zone pavilions at this year's COP28 will be unique as they will be located within existing buildings of Expo City Dubai and split across multiple floors.
- All floors, including split level pavilions, will be universally accessible.
- An exclusive Event Management Company has been appointed to provide the pavilion & office fit-outs with standardized tiered packages.
- Typically, exhibit spaces will be located on the ground floor and shared between 2 and 5 organizations to encourage collaboration and engagement.
- Offices and dedicated presentation & hospitality spaces will be allocated on the upper floors of your pavilion.
- There will also be an option to book shared presentation spaces in centralized areas for larger audiences.
- As part of this year's innovation process regarding pavilion spaces, we would like to learn more on how your pavilion strategy and content is aligned with the goals of the Paris Agreement.

EXPO CITY BUILDINGS

1st & 2nd Floors: Office & Presentation

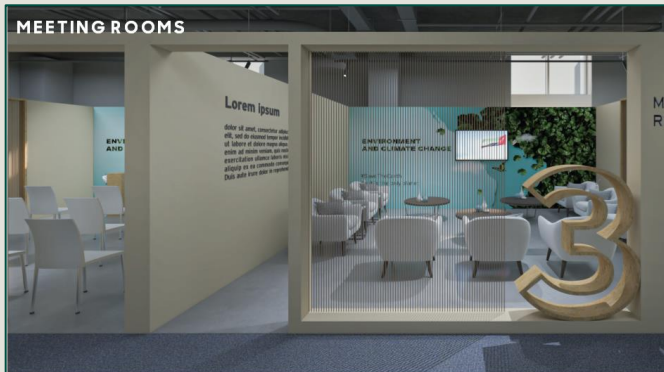

Room fit-out package example

Ground Floor: Pavilions



2

1

G

BLUE ZONE

PAVILIONS AND OFFICES

COP28UAE

PAVILION EXAMPLE

Typical requirements: Comprised of exhibit, presentation, office & hospitality spaces



2

2nd Floor: Office for 25 – 50 pax / Hospitality space for 30 – 50 pax

1

1st Floor: Office for 30 – 50 pax / Presentation space for 30 - 50 pax

G

Ground Floor: Shared exhibit space – Between 2 & 5 Organizations

Options:

Book a time slot in one of the Shared Presentation spaces if additional space is required



PAVILIONS &
OFFICES
ROOM FIT-OUT
PACKAGES

BUILDING YOUR ROOM FIT-OUT PACKAGES

We understand that finding the right space to accommodate your pavilions and offices is crucial to the success of your event. That's why we offer a range of space sizes within each building and room fit-out formats to help you plan your event with ease.

Our room fit-out packages are designed to maximize space and adapt to the internal building layouts, ensuring that you have everything you need to create a professional and engaging environment for your attendees. From small offices to large pavilions, we have the flexibility to cater to your needs and requirements.

The table details the pavilion sizes with the corresponding room fit-out packages and the layout options available to build your presence at COP28.

Pavilion & Room Type – Ground Floor					Offices & Room Type (1 st & 2 nd Floors)					
Pavilion Space Size m2	Room Fit-Out Package Options	Exhibition Only	Presentation Only	Exhibition and Presentation	Office Space Size m2	Office Fit-Out Options	Majlis VIP	Board Room	Presentation Conference Space	Admin Office
65-80	Tier 1 or upgrade to Tier 2	✓	✓		Min 20sqm	Base Build – Modular**	✓	✓	✓	✓
100-140	Tier 2 or upgrade to Tier 3		✓	✓	Office Room Fit-Out There are a range of office room fit-out that will allow delegations to create functional workspaces through to high level branded and engaging spaces. ** Furniture & Additional Services (Base Build Modular) To help your base build office space there are a range of items you can select to create your workspace, these include: <ul style="list-style-type: none"> • Furniture – Seating, Desks, Storage • AV & Technology – Office Equipment, Screens, Internet • Branding & Signage 					
150 - 195	Tier 3 or Custom		✓	✓						
Shared Pavilion up to 100 sqm*	Shared Pavilion Package or Custom	✓ (Shared)								

* Shared Pavilion - allocated spaces sizes will depend on the number of sharing groups – 2-5 organizations can be accommodated depending on required space.

PAVILION TIER 1

65m2 – 80m2 ROOM FIT-OUT PACKAGE

The Tier 1 package is a cost-effective option that still provides a strong Pavilion presence.

It includes two room setup options – exhibition or presentation – both designed to make the most of the available space and create a dynamic environment for engaging with your brand and message.

These rooms are versatile and have different layouts to accommodate all aspects of your COP program.

Each Tier 1 space offers:

- Internal and external branding, carpet, furniture package including welcome desk, lockable cupboard, chairs and furniture and AV & sound, microphones.
- Within each package there is flexibility to choose customised wall branding, furniture layouts and tailor on-screen messages and branding to suit your needs.
- Additional services and upgrades to core items, such as furniture, internet, AV, office equipment, catering and cleaning, can be ordered via the delegation online manual.



- Air Conditioning, Public Wi-Fi, Power & Lighting come as standard within each space

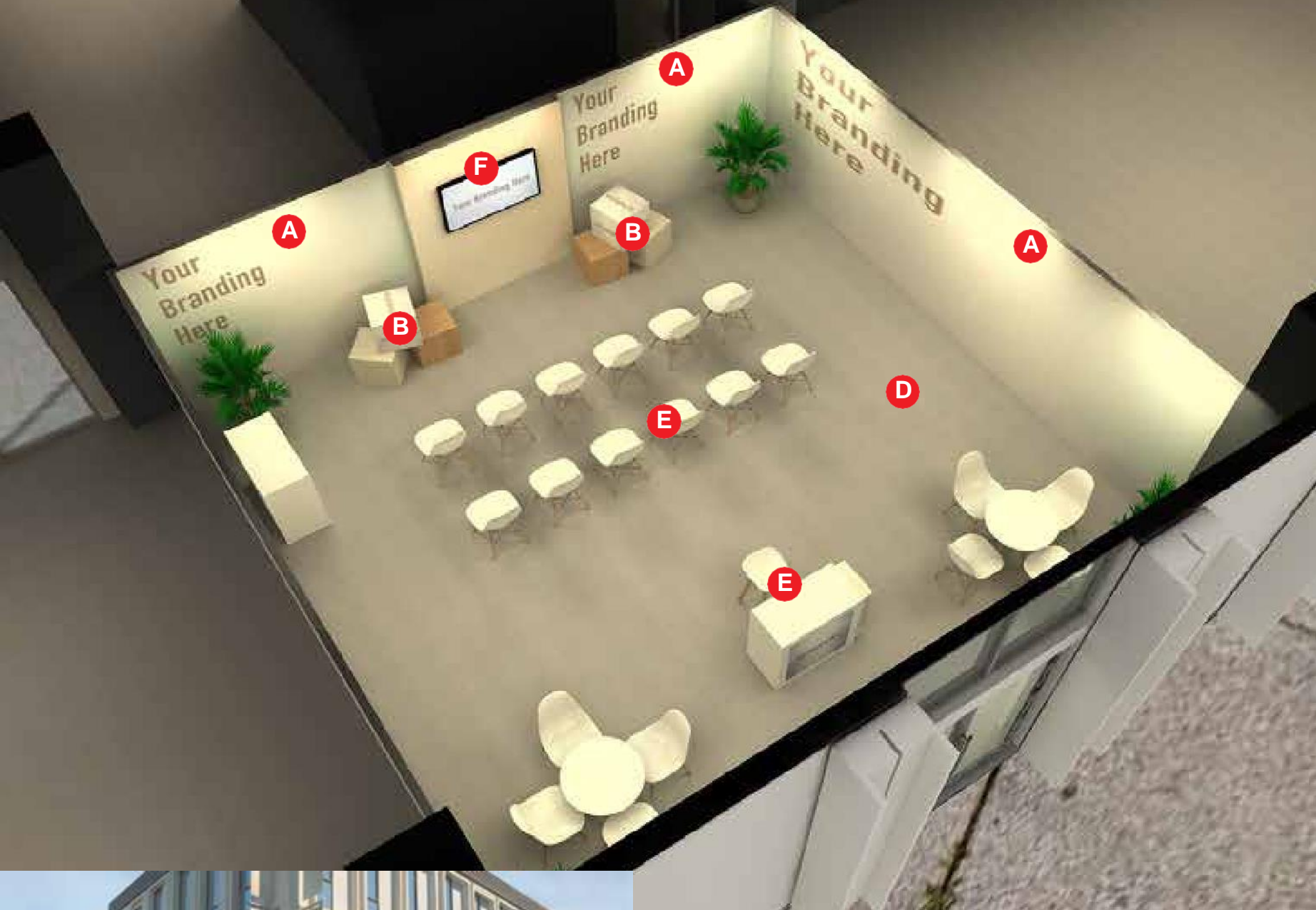

PRESENTATION PACKAGE TIER 1

PACKAGE INCLUSIONS

- A** WALLING WITH VINYL GRAPHICS
- B** CUBE BOXES WITH GRAPHICS
- C** BRANDING ON 3 GLASS PANELS ON THE EXTERIOR
- D** SUSTAINABLE CARPET FLOORING (COLOUR SUBJECT TO CHANGE)
- E** FURNITURE PACKAGE:
 - 2 X MEETING TABLES
 - 8 X CHAIRS WITH WOODEN LEG
 - 1 X RECEPTION COUNTER
 - 1 X HIGH STOOL
 - 12 X WHITE CHAIRS WITH METAL LEG 1 X LOCKABLE CABINET
 - 4 X PLANTS
 - 1 X BIN
- F** AUDIO VISUAL:
 - 1X 55" LED SCREEN 1 X PA SYSTEM
 - 2X SPEAKERS
 - 2 X WIRELESS MICS

ELECTRICS:

BASELINE SOCKETS AND LIGHTS SUITABLE FOR THE ROOM

**COST PER SQM SPACE +
FIT-OUT PACKAGE
\$1150**

*THESE VISUALS ARE FOR REFERENCE ONLY. THE SPACE BOOKED WITH THE ORGANISER MAY LOOK DIFFERENT DEPENDING ON THE SPACE SIZE, LOCATION AND ORIENTATION. SOME LARGER SPACES WILL RECEIVE ADDITIONAL FURNITURE.

PAVILION TIER 2

100 m2 – 140 m2 ROOM FIT-OUT PACKAGE

The mid-tier room fit-out design offers a perfect solution for those seeking a space with impact, and ample opportunity for brand exposure.

Attendees will be engaged and inspired in a comfortable, spacious environment that promotes learning and collaboration.

The exhibition space will reflect your brand, while the presentation space is designed for immersive learning and engagement. Or, for a versatile option that combines the best of both worlds, choose a combined exhibition and presentation space.

The rooms have several configurations that will meet the needs of your delegation's approach to COP28.

Each Tier 2 space offers:

- Internal and external branding, carpet, furniture package – chairs, tables, seating, lockable cupboard, presentation AV & sound and stage.
- Within each package there is flexibility to choose and customise wall branding, furniture layout and on-screen messages and branding.
- Additional services and upgrades to core items, such as furniture, internet, AV, office equipment, catering and cleaning, can be ordered via the delegation online manual.

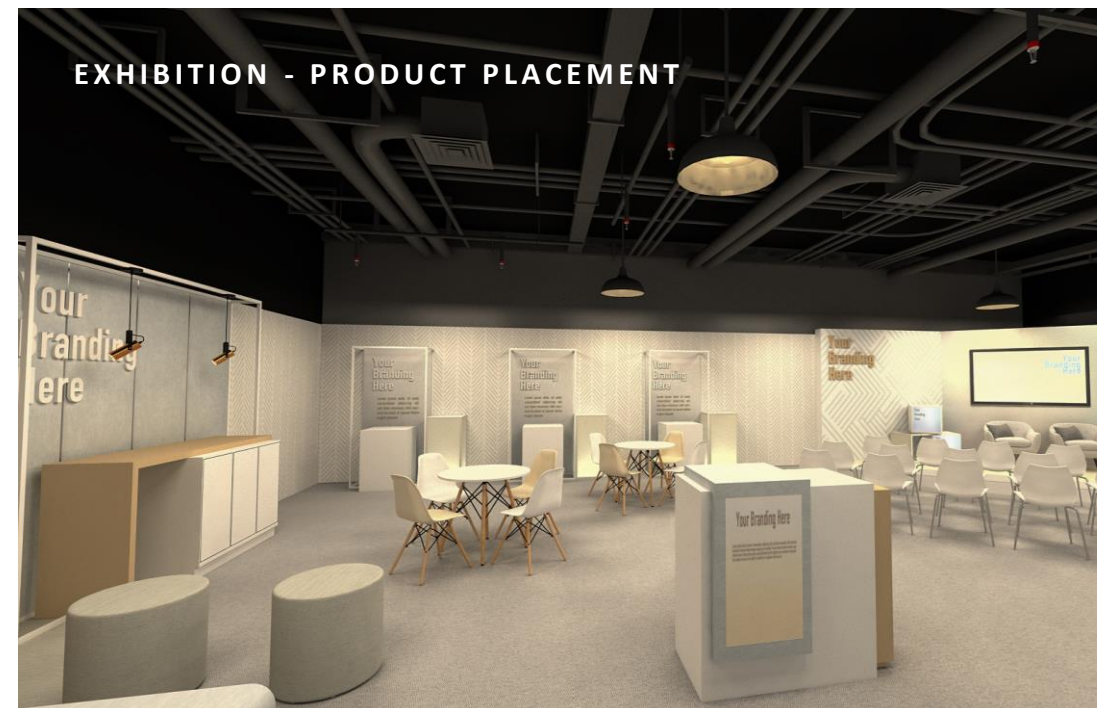
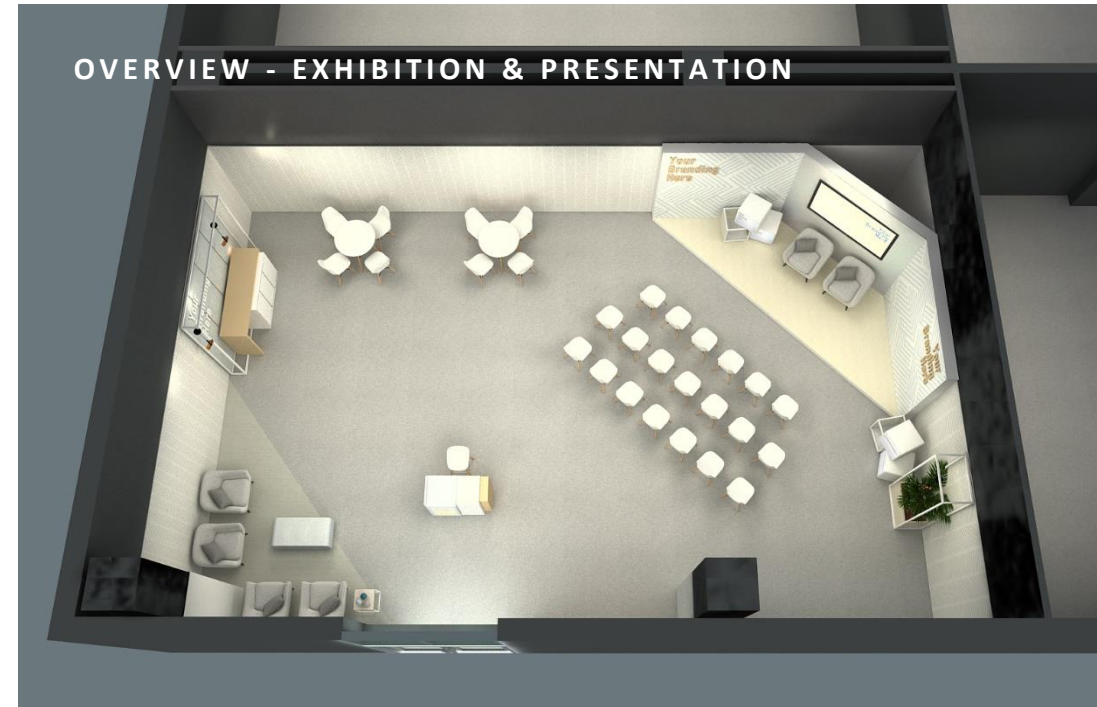

- Air Conditioning, Public Wi-Fi, Power, Lighting come as standard within each space



PACKAGE INCLUSIONS

- A** WALLING WITH VINYL GRAPHICS
- B** CUBE BOXES WITH GRAPHICS
- C** BRANDING ON 3 GLASS PANELS ON THE EXTERIOR
- D** SUSTAINABLE CARPET FLOORING (COLOUR SUBJECT TO CHANGE)
100MM HIGH STAGE PLATFORM (21SQM SUBJECT TO ROOM SIZE)
- E** FURNITURE PACKAGE:
 - 2 X ROUND MEETING TABLES
 - 8 X CHAIRS WITH WOODEN LEG
 - 6 X LOUNGE CHAIRS
 - 1 X COFFEE TABLE
 - 1 X RECEPTION COUNTER
 - 1 X HIGH STOOL
 - 20 X WHITE CHAIRS WITH METAL LEG 1 X LOCKABLE CABINET
 - 1 X PLANT
 - 1 X BIN
 - 2X CUBE BOXES
- F** AUDIO VISUAL:
 - 1X 65" LED SCREEN 1 X PA SYSTEM
 - 2X SPEAKERS
 - 2 X WIRELESS MICS

ELECTRICS:

BASELINE SOCKETS AND LIGHTS SUITABLE FOR THE ROOM



PRESENTATION PACKAGE TIER 2

**COST PER SQM SPACE +
FIT-OUT PACKAGE
\$1280**

*THESE VISUALS ARE FOR REFERENCE ONLY. THE SPACE BOOKED WITH THE ORGANISER MAY LOOK DIFFERENT DEPENDING ON THE SPACE SIZE, LOCATION AND ORIENTATION. SOME LARGER SPACES WILL RECEIVE ADDITIONAL FURNITURE.

PAVILION TIER 3

150m2 – 195m2 ROOM FIT-OUT PACKAGE

The high level space fit-outs incorporate features including digital displays, brand positioning, and interactive product demonstrations. With our flexible layout and product placement options, you can customise your space format to suit your delegation programs and team use.

The room layouts combine exhibition and presentation areas to create the ideal environment for your specific needs. Each space will help provide a professional and engaging experience for all attendees.

Each Tier 3 space offers:

- A high-specification infrastructure build incorporating recycled and reuse materials
- Key features include external & internal branding 3D, light box and fabric graphics, carpet, furniture package and presentation pack with large LED screen, PA and room LED screens.
- Within each package there is flexibility to customise wall branding and furniture layouts to create an engaging space with tailored on-screen messages and branding.
- Additional services and upgrades to core items, such as furniture, internet, and AV can be ordered along with other services such as office equipment, catering and cleaning, via the delegation online manual.

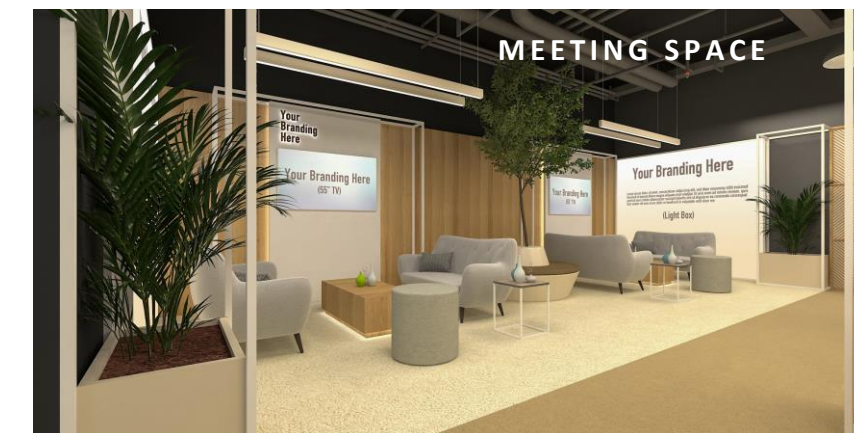
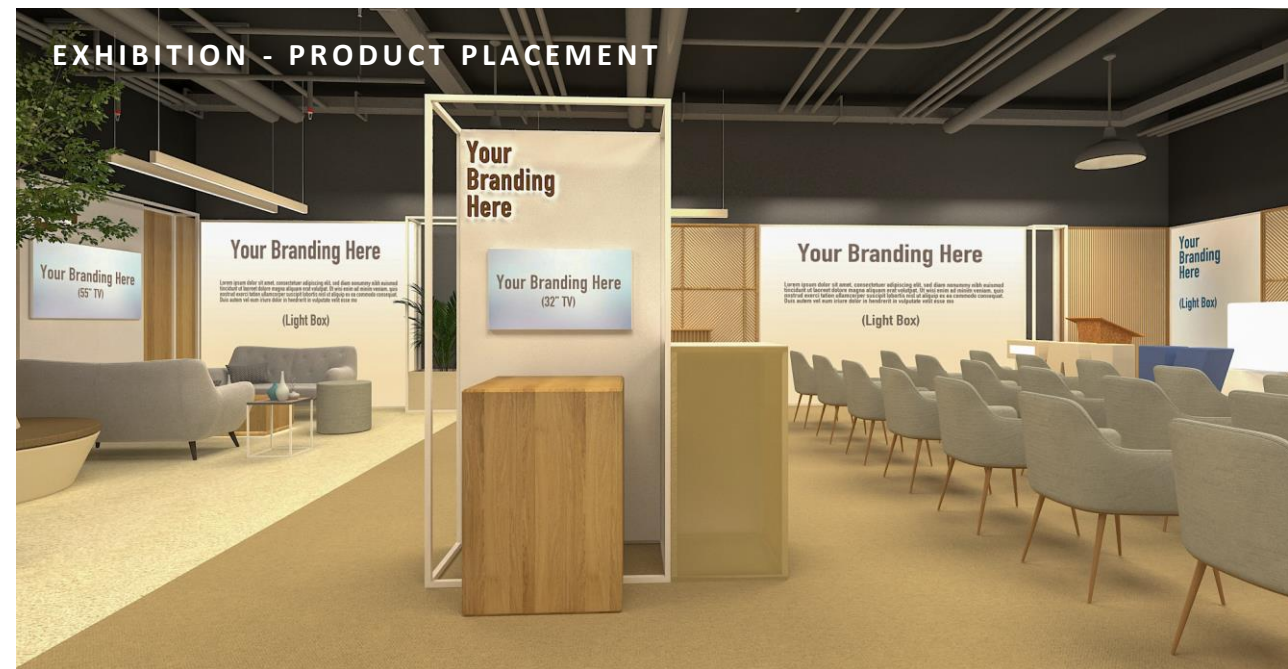

- Air Conditioning, Public Wi-Fi, Power, Lighting come as standard within each space

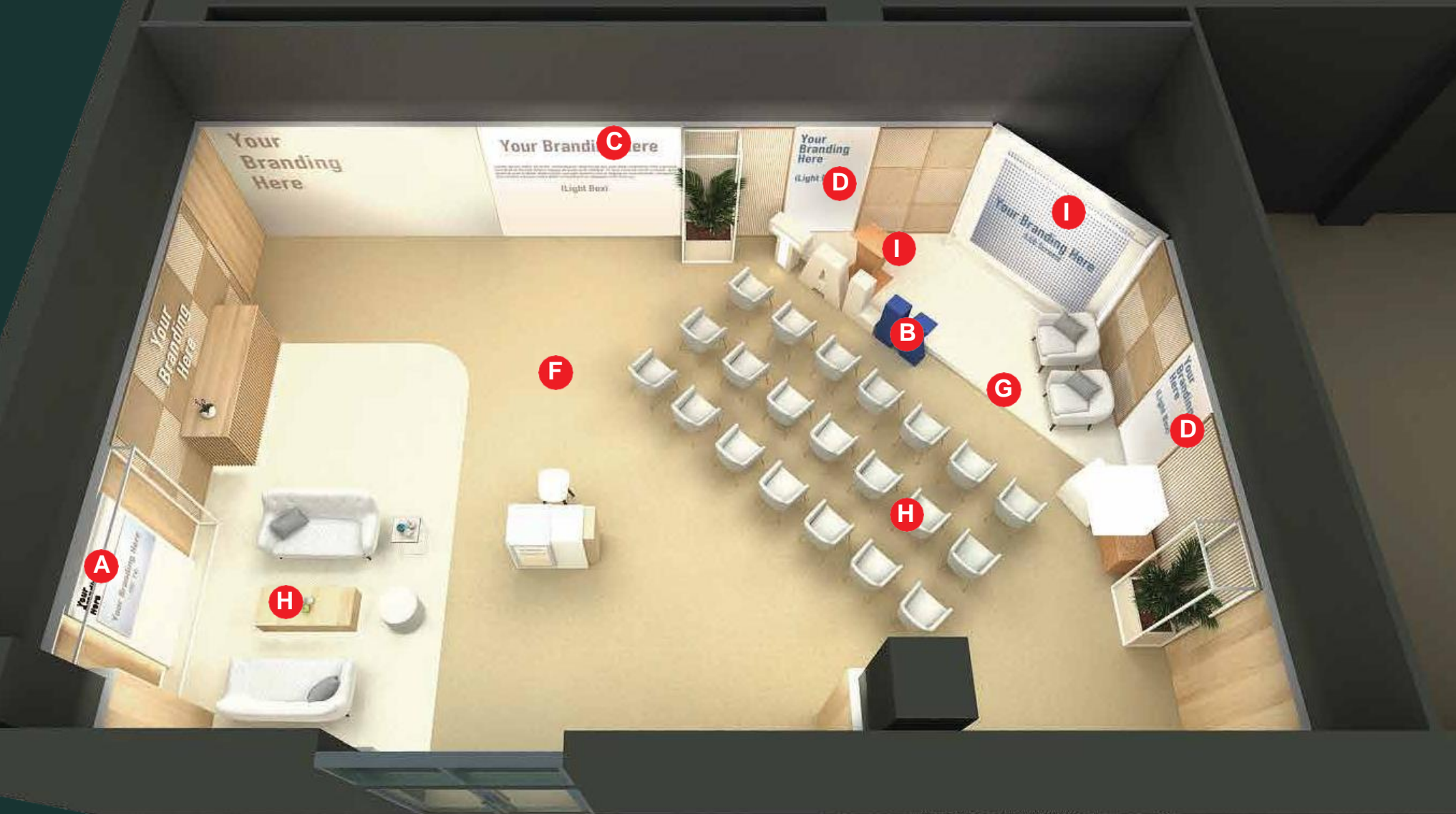

PACKAGE INCLUSIONS

- A** WALLING WITH VINYL GRAPHICS
 - B** 3M LONG 3D TEXT
 - C** 3M WIDE LIGHT BOX WITH FABRIC GRAPHICS
 - D** 2 X 1.5M WIDE LIGHT BOX WITH FABRIC GRAPHICS (ARTWORK TO BE SUPPLIED BY THE CLIENT)
 - E** BRANDING ON 3 GLASS PANELS ON THE EXTERIOR
 - F** SUSTAINABLE CARPET FLOORING WITH UNDERLAY (COLOUR SUBJECT TO CHANGE)
 - G** 100MM HIGH STAGE PLATFORM (SQM SUBJECT TO ROOM SIZE)
 - H** FURNITURE PACKAGE:
 - 2 X ROUND MEETING TABLES
 - 8 X CHAIRS WITH WOODEN LEG
 - 6 X LOUNGE CHAIRS
 - 1 X COFFEE TABLE
 - 1 X RECEPTION COUNTER
 - 1 X HIGH STOOL
 - 20 X WHITE CHAIRS WITH METAL LEG 1 X LOCKABLE CABINET
 - 1 X PLANT
 - 1 X BIN
 - 2 X CUBE BOXES
 - I** AUDIO VISUAL:
 - 1 X 65" LED SCREEN 1 X PA SYSTEM
 - 2 X SPEAKERS
 - 2 X WIRELESS MICS
- ELECTRICS:**
BASELINE SOCKETS AND LIGHTS SUITABLE FOR THE ROOM



PRESENTATION PACKAGE TIER 3

COST PER SQM SPACE + FIT-OUT PACKAGE
\$1410

*THESE VISUALS ARE FOR REFERENCE ONLY. THE SPACE BOOKED WITH THE ORGANISER MAY LOOK DIFFERENT DEPENDING ON THE SPACE SIZE, LOCATION AND ORIENTATION. SOME LARGER SPACES WILL RECEIVE ADDITIONAL FURNITURE.



OFFICES SPACES & LAYOUT

OFFICES

Office spaces will be located on the first and second floors of buildings. If you are allocated a pavilion space and offices, these will be in the same building.

We have a range of office fit-out designs, from a basic build modular approach to those suitable for fully branded professional meetings or multi-use environments.

There are four room types to help you create a functional multi-use approach; these include:

- Administration office
- Board room
- Majlis / VIP
- Presentation

We can help you create an approach that suits your requirements and budget.

Additional services and upgrades to core items, such as furniture, AV, office equipment, catering, and cleaning can be ordered via the delegation manual.

EXAMPLE LAYOUT FIXED ROOMS

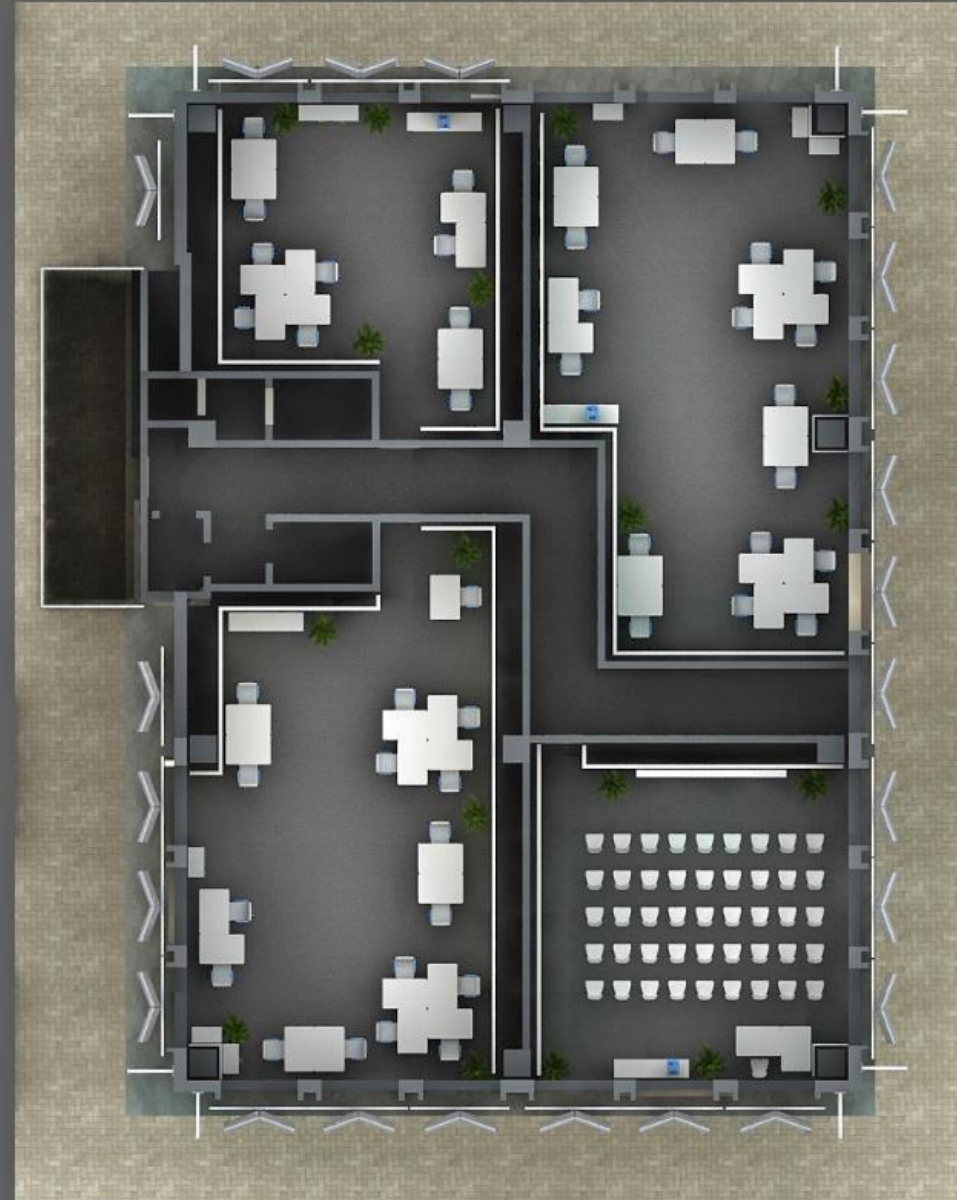

EXAMPLE LAYOUT OPEN PLAN



OFFICES – BASE BUILD

Your office space build will be determined by the building you are allocated and your individual needs, including:

- Total space requirement
- The number of office spaces required
- The format required for each room space

This base build office room fit-out caters for a single office or a series of interconnected offices.

This package (based on 8m x 4m) provides a flexible and affordable approach and includes:

- Wooden walling (2.4m high)
- Glass-frosted lockable door
- 4 x sockets
- Carpet

**COST PER SQM
SPACE + BUILD
\$800**

Branding, furniture, office equipment, storage and internet connectivity will need to be ordered to suit required room use.

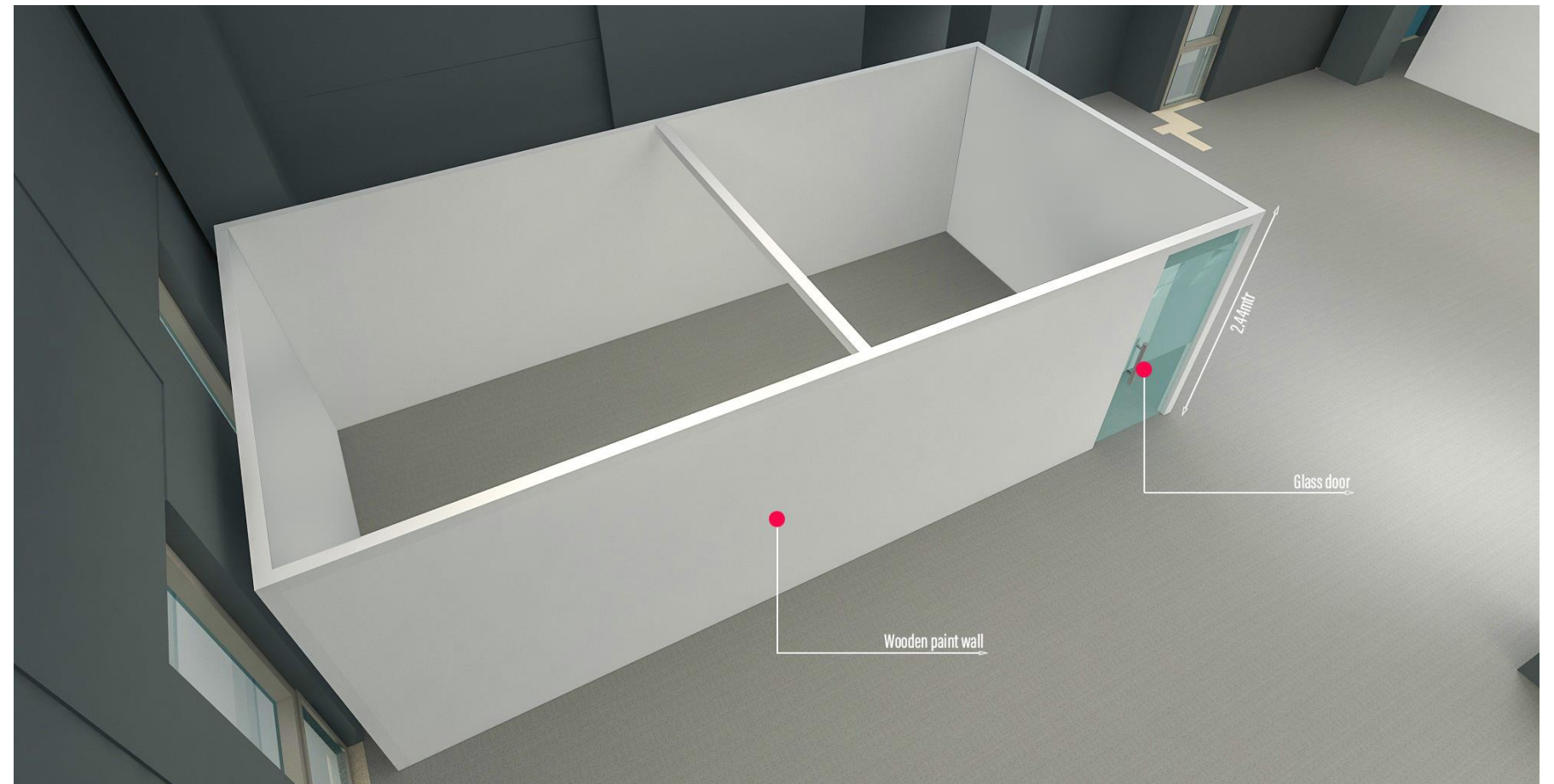

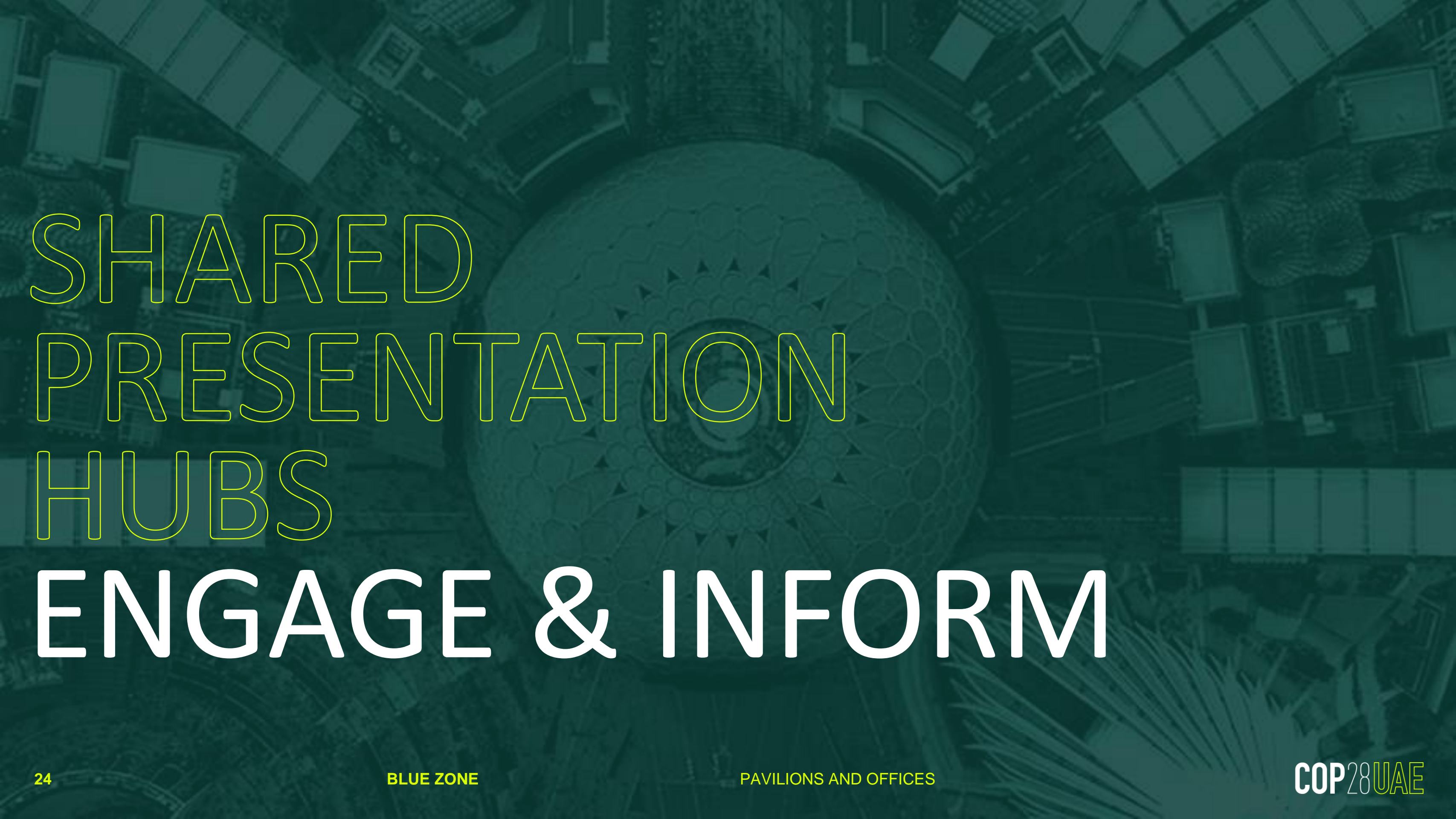

SHARED
PRESENTATION
HUBS
ENGAGE & INFORM

SHARED PRESENTATION HUBS

The Shared Presentation hubs are situated in the centre of the Mobility and Opportunity districts. These spaces are open to all delegations to book one off or a series of sessions throughout the event.

They are designed to provide a collaborative environment where sector specialists can come together to cross-pollinate messages and ideas, driving footfall to high-impact areas and expanding reach to new audiences.

These spaces will be professionally programmed and marketed to attendees and will be equipped with stage management and production facilities as well as live streaming capabilities to ensure high-quality panel discussions, briefings, and presentations.

By fostering collaboration and thematic focuses, these hubs offer an excellent opportunity to showcase your climate change progress and plans and engage with attendees at COP28 UAE.



THANK YOU



COP²⁸
UAE

If you require any further information or clarifications, please contact bluezonepavilion@climateenvoy.gov.ae